

FOR LEASE

37 SHERWOOD TERRACE - UNIT 131
LAKE BLUFF, IL

CONTACT US TODAY:

Eric Wagener

847-706-7155

ewagener@owenwagener.com

Owen Wagener & Co.

941 N. Plum Grove Rd., Suite B

Schaumburg, IL 60173

www.owenwagener.com



MULTI-TENANT
FLEX

SPECS:

- GREAT NORTH SHORE LOCATION
- PRIVATE DRIVE-IN DOOR
- EXCELLENT WINDOW LINE
- PROFESSIONALLY MANAGED & MAINTAINED

Space Available:	1,250 SF
Total Building Size:	35,458 SF
Office Size:	630 SF
Acres:	2.59 Acres
Description:	Multi-Tenant Flex
Ceiling Height:	16' Clear
Parking:	Ample
Loading:	Drive-in Door
Year Built:	1988
Zoning:	Light Industrial
Power:	100 Amps, 110 Volts
Monthly Rent:	\$1,250.00 Modified Gross

All information herein is from sources reliable but not guaranteed accurate. Subject to errors, omissions, and to changes of price and terms, prior sale or lease, all without notice.

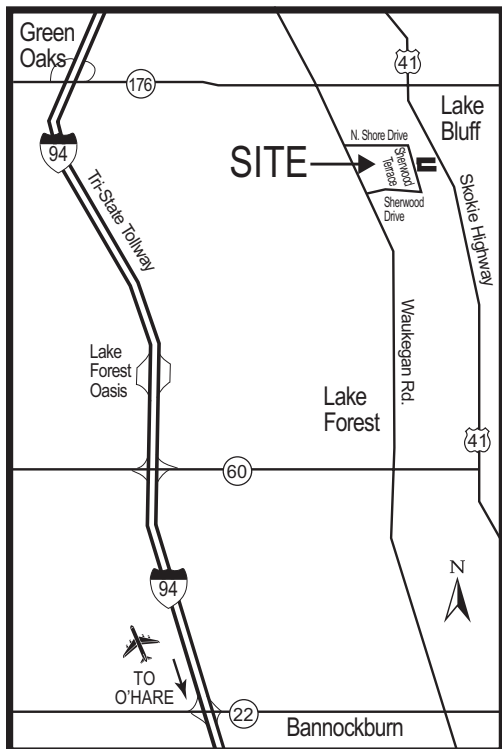

37 SHERWOOD TERRACE - UNIT 131 LAKE BLUFF, IL

1,250 SQUARE FEET

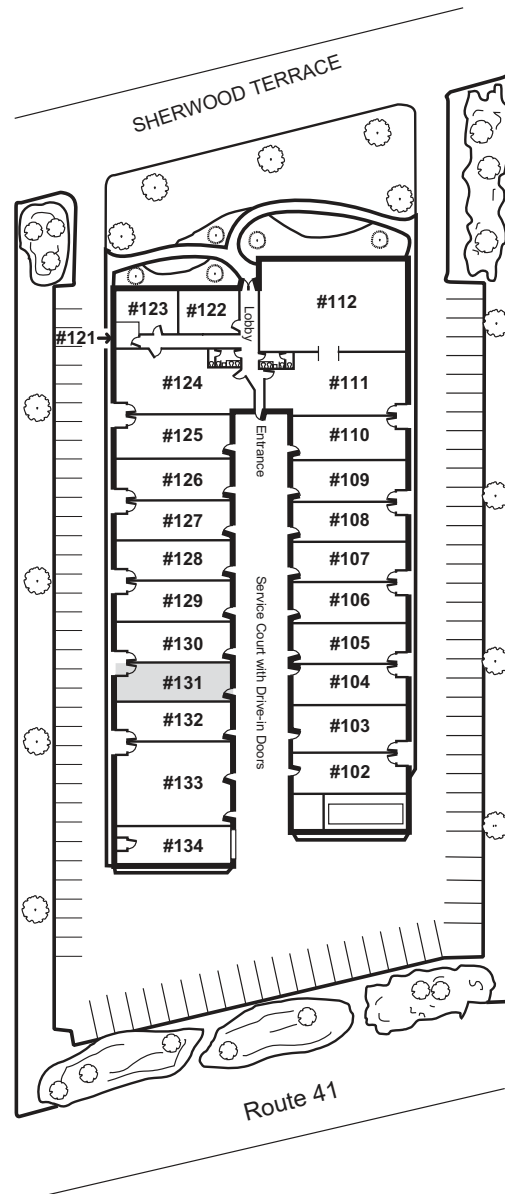
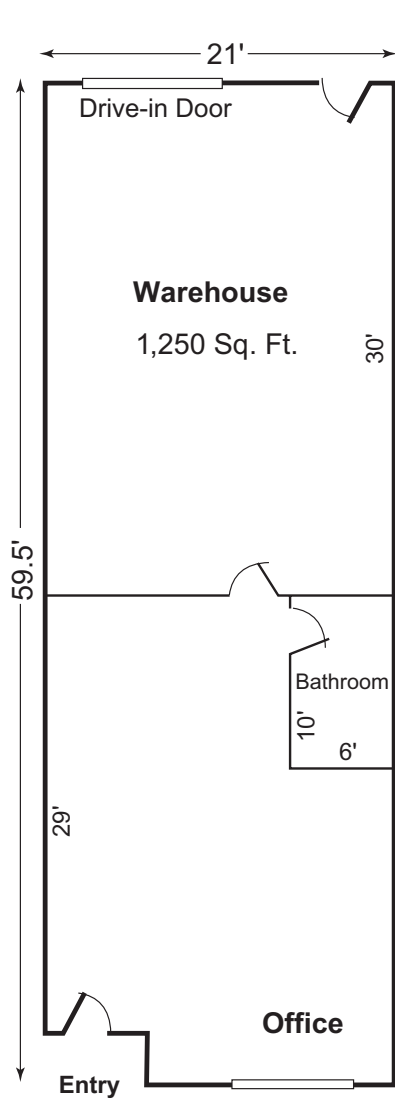

YOUR CHICAGOLAND COMMERCIAL
REAL ESTATE EXPERT, SINCE 1964.