

## FOR LEASE

37 SHERWOOD TERRACE - SUITE 102-103  
LAKE BLUFF, IL

CONTACT US TODAY:

**Eric Wagener**

847-706-7155

ewagener@owenwagener.com

Owen Wagener & Co.

941 N. Plum Grove Rd., Suite B

Schaumburg, IL 60173

www.owenwagener.com

### MULTI-TENANT FLEX SPACE



### SPECS:

- GREAT NORTH SHORE LOCATION
- TWO DRIVE-IN DOORS W/ WAREHOUSE SPACE
- 5 PRIVATE OFFICES WITH KITCHEN
- ADDITIONAL MEZZANINE STORAGE
- PROFESSIONALLY MANAGED & MAINTAINED

Space Available:	2,500 SF
Total Building Size:	35,458 SF
Office Size:	1,620 SF
Acres:	2.59 Acres
Description:	Flex
Heat:	Gas Forced Air
Parking:	Ample
Loading:	Two Drive-in Doors
Year Built:	1988
Monthly Rent:	\$2,500.00 Modified Gross

\* Included up to 2022 estimates. Tenant participates in increase in tax & operating expenses in excess of 2022 estimates, if any.

Members of this firm have an ownership interest in property

All information herein is from sources reliable but not guaranteed accurate. Subject to errors, omissions, and to changes of price and terms, prior sale or lease, all without notice.

# 37 SHERWOOD TERRACE - UNIT 102-103 LAKE BLUFF, IL

2,500 SQUARE FEET

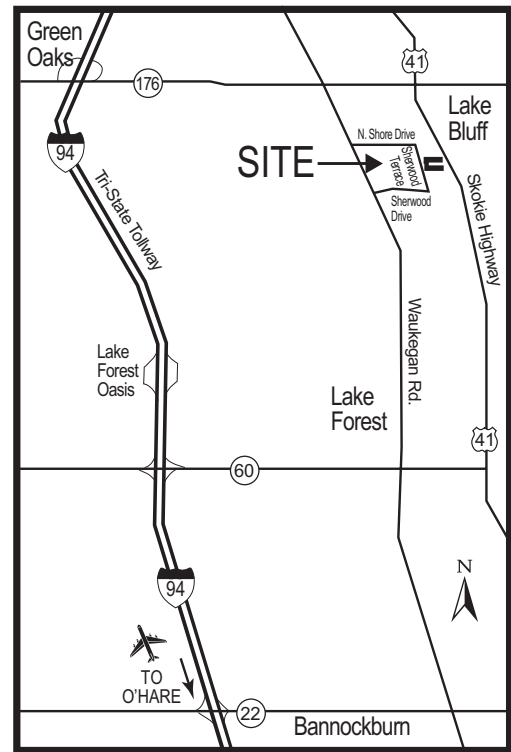
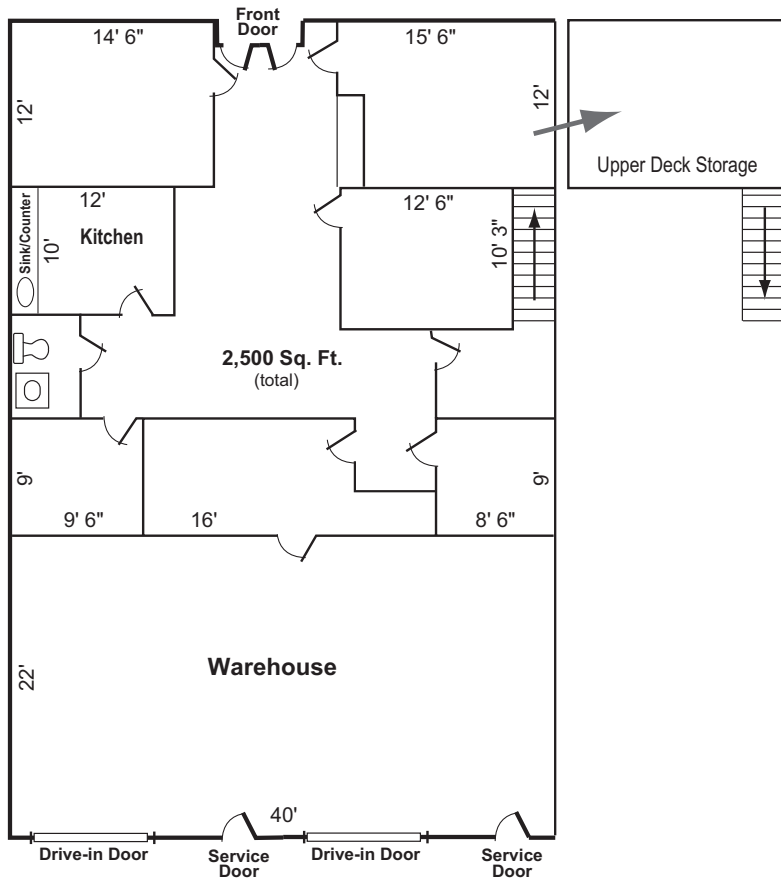

YOUR CHICAGOLAND COMMERCIAL  
REAL ESTATE EXPERT, SINCE 1964.

[WWW.OWENWAGENER.COM](http://WWW.OWENWAGENER.COM)